

THE ICONIC FORD FALCON XB GT

SCALE
1:8



Car Upper Body



Duel (1971)

Published weekly
UK: £19.99 AUS: \$39.99



POST-APOCALYPTIC EDITION

THE ICONIC FORD FALCON XB GT

ISSUE 94

ASSEMBLY GUIDE

3

Side scoops are fitted to the upper body of the car.

CARS ON SCREEN

7

Mike Renaut explains why Steven Spielberg's feature film *Duel* (1971), a filmed-for-TV movie about a motorist terrorised by a faceless truck driver, has left a lasting legacy.

YOUR MODEL

You will be building a 1:8 scale replica of a customised 1973 Ford Falcon XB GT. Features include a lift-up bonnet that reveals a detailed engine, opening doors, wind-down windows and an 'active' steering wheel. A remote-control fob illuminates the main lights, brake lights and indicators.

Scale: 1:8
Length: 62cm
Width: 25cm
Height: 19cm
Weight: 7+kg



Ford Motor Company
trademarks and trade dress
used under licence to GRE
for Groupe ELIGOR

Official
Licensed Product

CUSTOMER SERVICE, SUBSCRIPTIONS & BACK ORDERS

Please visit hachettepartworks.com/contact to get in touch.

Published by Hachette Partworks Ltd
4th Floor, Jordan House, 47 Brunswick Place,
London, N1 6EB
www.hachettepartworks.com



© 2026 Hachette Partworks Ltd
© 2026 Ford Motor Company
Distributed in the UK and Republic of Ireland by Marketforce.
Printed in the United Kingdom
ISSN 2976-5811

Complete in 130 issues.

ALL RIGHTS RESERVED

Items may vary from those shown.
All parts belong to a kit. Collectors' item for adults. Not suitable for children under 14. Some parts may have sharp edges, please handle them with care.

The installation of electronic parts must always be carried out by an adult. When replacing batteries, use the same type of batteries. Please ensure that the battery compartment is securely fastened before you use the model again. Used batteries should be recycled. Please make sure to check with your local council how batteries should be disposed of in your area. Batteries can present a choking danger to small children and may cause serious harm if ingested. Do not leave them lying around and keep any spare batteries locked away at all times.

The editor's policy is to use papers that are natural, renewable and recyclable products and made from wood grown in sustainable forests. The logging and manufacturing processes are expected to conform to the environmental regulations of the country of origin.

In the event of a significant increase in production and transport costs, the publisher reserves the right to modify its selling prices.

MANAGING DIRECTOR – Isabelle Couderc
EDITORIAL DIRECTOR – Helen Nally
MARKETING DIRECTOR – Elise Windmill
PRODUCTION DIRECTOR – Sema Sant Anna
MANAGING EDITOR – Sarah Gale
PROJECT EDITOR – Gary Webb
DISTRIBUTION MANAGER – Paul Smith
PRODUCT MANAGER – Rhys Myrner



For our
environmental
policy in full
please scan the
QR code here



NOT SUITABLE FOR CHILDREN
UNDER THE AGE OF 14.
This product is not a toy and is
not intended for use in play.

Editorial and design: Windmill Books Ltd

Picture credits: Front Cover: Alamy: Allstar Picture Library Limited bc: Richard Bryden bl: Jess Esposito and David Burton: main: Shutterstock: Steven Giles background. Interior: Alamy: Allstar Picture Library Limited 7. Step-by-step photography: Richard Bryden Model photography: Jess Esposito and David Burton

Windmill Books has made every attempt to contact the copyright holder. If you have any information please contact Sophie Mortimer: smortimer@windmillbooks.co.uk

t=top, c=centre, b=bottom, l=left, r=right, u=upper



Stage 94: Car Upper Body

Side scoops are fitted to the upper body of the car.



List of parts:

94A Car upper body

94B Side scoop (right)

94C Side scoop (left)

PS05 Three* 2.3 x 4mm PB screws

* Including spare

PB = Pan head for plastic

Area of assembly



Stage 94: Car Upper Body



STEP 1

Identify the right and left side scoops, **94B** and **94C**.

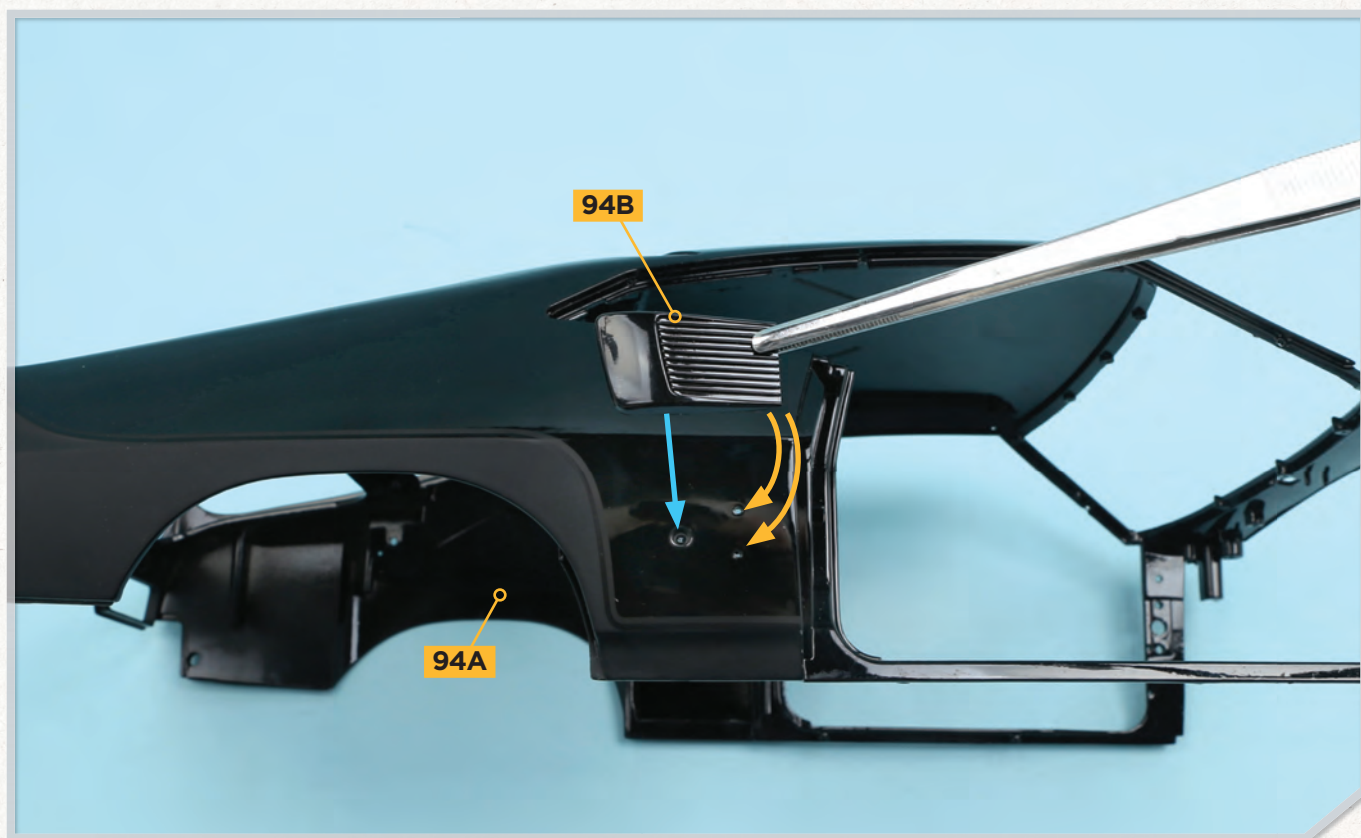

STEP 2

Fit the right side scoop **94B** to the right side of the car body **94A**. Two pegs on the back of part **94B** fit into small holes in part **94A** (yellow arrows) and a raised screw socket on part **94B** fits into the larger hole (blue arrow).

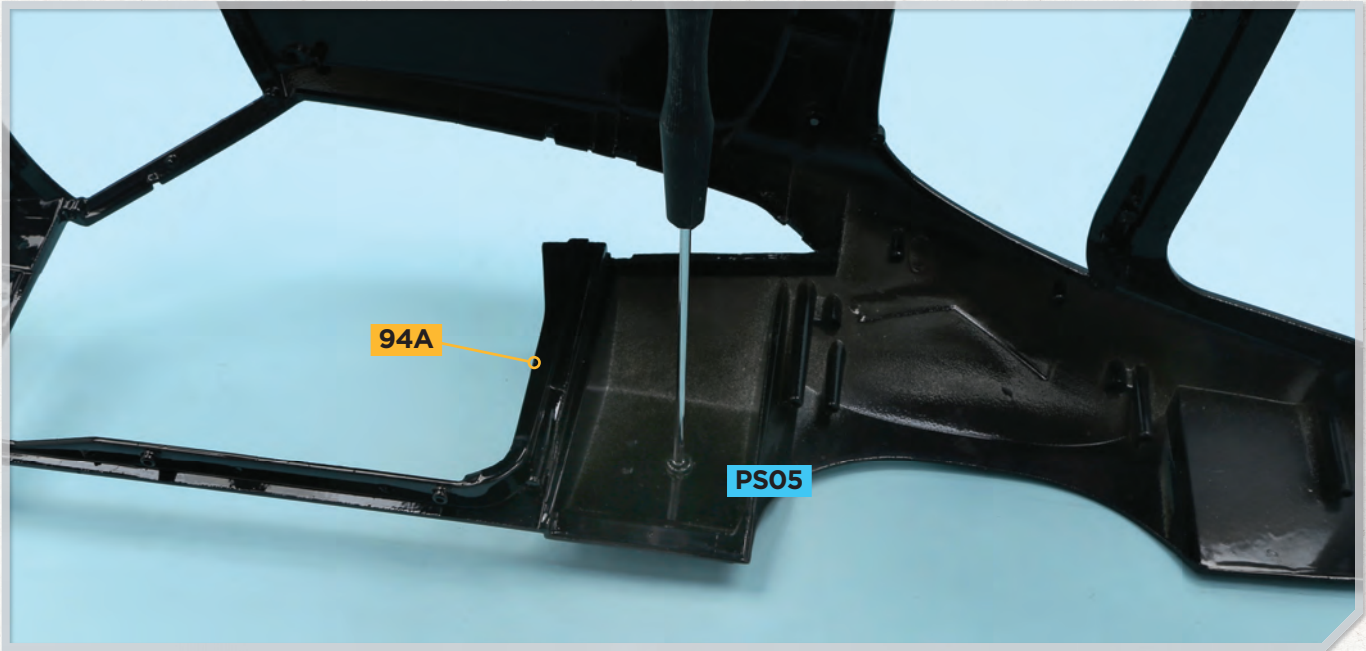

STEP 3

Adjust the position of the assembly so that you can access the inside of the car body **94A**. Fix the side scoop in place with a **PS05** screw.

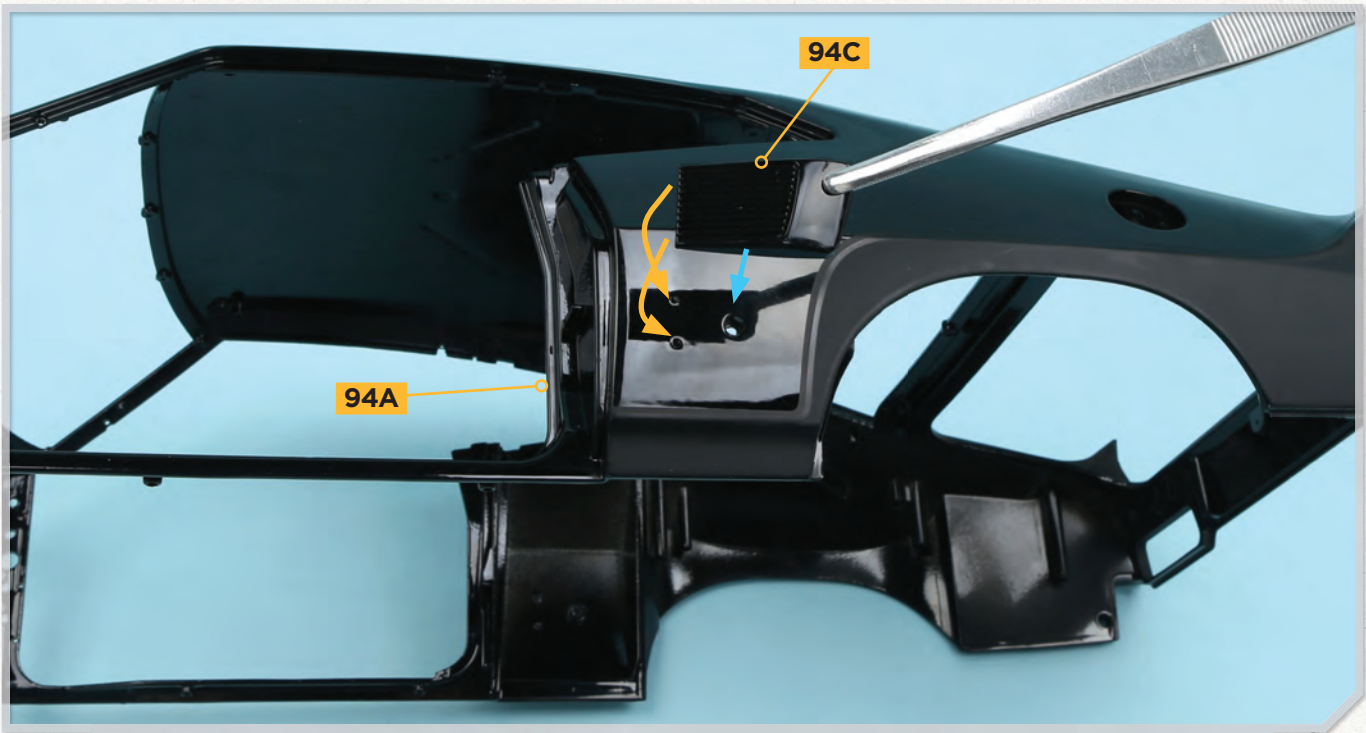

STEP 4

Fit the left side scoop **94C** to the left side of the car body **94A**. Two pegs on the back of part **94C** fit into small holes in part **94A** (yellow arrows) and a raised screw socket on part **94C** fits into the larger hole (blue arrow).

Stage 94: Car Upper Body

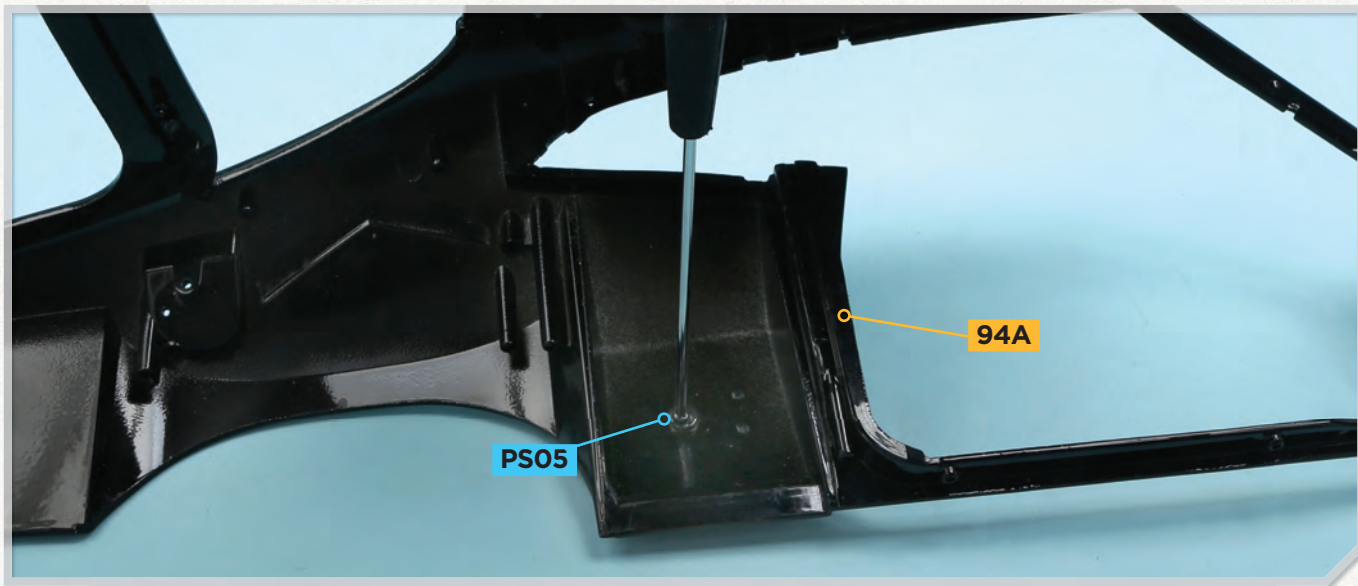

STEP 5

Adjust the position of the assembly so that you can access the inside of the car body **94A**. Fix the side scoop in place with a **PS05** screw.

COMPLETED ASSEMBLY

Side scoops have been fitted to the upper body of the car.



Duel (1971)

Steven Spielberg's second feature film, after his 1964 directorial debut *Firelight* (1964), was *Duel*. As explained here by Mike Renaut, the legacy of this filmed-for-TV movie about a motorist terrorised by a truck driver has endured.

The screenplay for *Duel* was by Richard Matheson, who had been almost run off a California freeway by a trucker in November 1963. Matheson wrote about his experience for *Playboy* magazine in April 1971. The story was then earmarked as an ABC Movie of the Week and Spielberg's secretary suggested he apply to be director. Spielberg had just directed an episode of *Columbo*, so he was confident he could deliver *Duel* on the limited budget and 10-day shooting schedule required.

The plot was simple. An innocent salesman is hounded across California's desert roads by a truck driver apparently intent on killing him, with no explanation why. Spielberg insisted they film on location with cameras mounted on opposite sides of the vehicles, so providing double the footage and allowing the maximum number of locations with minimal travel.

STARRING CARS

Lead character David Mann (Dennis Weaver) drives a red Plymouth Valiant sedan, the colour chosen to stand out from the dusty desert backgrounds. It is thought that three vehicles were used during filming: a 1969 disguised to look like a 1970, a genuine 1970 and a 1971. Badges and trim were removed to make the cars appear identical.

Mann (Dennis Weaver) tries to escape from the monstrous truck as it chases him across California.

Spielberg held a truck audition and chose a 1957 Peterbilt 281, probably because it was the only conventional (bonneted) truck he was offered, the others all being flat-fronted, and so lacking a menacing 'nose' and 'eyes'. The Peterbilt had previously been an oil tanker and it came with a trailer designed to be permanently attached. With its Caterpillar 1637B turbocharged engine, running empty and on flat ground the Peterbilt 281 was capable of over 65mph, although the footage was occasionally undercranked to make it seem faster.

The crew would decorate the truck each day with extra dirt and dead insects. The final car crash over the cliff was achieved by stunt driver Carey Loftin jumping out at the last possible moment (which is

why the driver's door swings open). The scene used was the second attempt, because the first time the truck stuck on the edge, leaving the burning Valiant to fall alone. Continuity required that the burnt out car was lifted back up for the second attempt - the other Valiants didn't have the same front end damage as the stunt car. All evidence of the vehicles was removed by the film crew and, despite various claims, nothing film-related remains there today.

The television movie was such a success its 74-minute runtime was edited with some 15 minutes of extra footage to allow for a cinema release. Spielberg spent two days filming some extra scenes. The film is inventive, tense and above all thrilling - one of the greatest road/horror movies ever made. ■



COMING IN ISSUE 95



• ASSEMBLY GUIDE

Rear wheel arches and an air intake vent are fitted to the car body.

NEW PARTS

Right rear wheel arch, front air intake vent, left rear wheel arch and screws.



Published weekly
UK: £19.99
AUS: \$39.99



hachettepartworks.com/FordFalcon